

EXPLOSION PROOF/DUST IGNITION PROOF VACUUMS

CLASS I GROUP D AND CLASS II GROUP F&G ATMOSPHERES



The Explosion Proof/Dust Ignition Proof Vacuum is UL listed and is ideal for the pick-up of hazardous material such as flammable liquids, finely pulverized dust and more. This heavy-duty electric vacuum operates wet or dry in Class I, Group D and Class II, Group F&G atmospheres and is available in 15 gallon tank configurations. They feature a 22-gauge, non-sparking stainless steel tank. This vacuum can include an U.L.P.A. filter if needed for your application. Includes a 14-3/50' STWA safety cable, static-conductive casters and rear wheels.

Specifications

MODEL	C88015-02	C88015-04
Power	1.70 HP	1.70 HP
Tank Size	15 gallon	15 gallon
Wet Capacity	12 gallon	12 gallon
Dry Capacity	1.9 cu ft	1.9 cu ft
Airflow	120 CFM	120 CFM
Waterlift	69"	69"
Voltage	115v 15amp	115v 15amp
Total Filter Area	603 sq in	1769 sq in
ULPA Filter Area	N/A	1,224 sq in
# of Prefilters	1	3
Manometer	No	Yes
Casters	3"	3"
Wheels	8"	8"
Cord	50 ft	50 ft
Weight	86 lbs	96 lbs

Class I Group D Atmospheres

butane, cyclopropane, ethane, ethanol, gasoline, methane, methanol, octane, pentane, petroleum, propane, turpentine, vinyl chloride

Class II Group F Atmospheres

carbon black, charcoal, coke or coal dusts

Class II Group G Atmospheres

flour, starch or grain, or combustible dusts having resistivity of 108

OPTIONAL TOOL KIT

490007 Explosion Proof Tool Kit

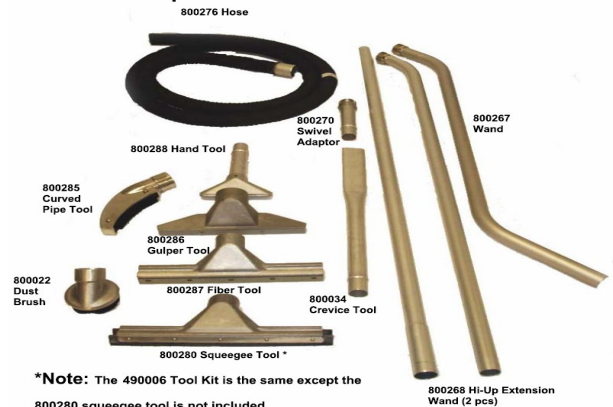

*Note: The 490006 Tool Kit is the same except the 800280 squeegee tool is not included.

P/N: 490006:

Explosion Proof Vacuum 30G Tool Kit, **Dry only.**

P/N: 490007:

Explosion Proof Vacuum 30H Tool Kit, **Wet/Dry.**

- 14" Squeegee - 490007 only
- 5" Round Dusting Brush
- 12' x 1 1/2" Hose Assembly
- 6' x 1 1/2" Curved Pipe Tool
- 12" Gulper Tool
- 14" Fiber Floor Tool

MINUTEMAN INTERNATIONAL INC.
14N845 US ROUTE 20
PINGREE GROVE, IL 60140
WEB: www.Minutemanintl.com

Phone: 800-323-9420
Fax: 800-422-6933
E-mail: customerservice@minutemanintl.com

MINUTEMAN BRAND IS A FULL LINE MANUFACTURER OF SWEEPERS AND SCRUBBERS; AS WELL AS CRITICAL FILTER VACUUMS, INDUSTRIAL AND COMMERCIAL VACUUMS, FLOOR AND CARPET MACHINES, AND LITTER VACUUMS FOR COMMERCIAL AND INSTITUTIONAL FACILITIES. POWERBOSS BRAND IS A FULL LINE MANUFACTURER OF SWEEPERS AND SCRUBBERS FOR INDUSTRIAL FACILITIES.

Flammable Liquid Recovery Vacuum

Pneumatic-Operated Vacuum



Key Features

- Unit is air-operated with no moving parts, thus simplifying maintenance
- A silencer attached to the unit makes the 701 quieter than any comparable electric vacuum
- Includes liquid shut-off for wet applications
- Sturdy all-steel dolly with 5" conductive wheels for easy transporting
- Standard with an explosion-proof tool kit with 14" floor squeegee tool
- Special neoprene 25' x 1-1/2" grounded vacuum hose with Nitrile Core
- Pressure relief valve
- Intake hose closure
- Locking lid latches

Markets

- Petroleum Refining Facilities
- Airports
- Fuel Servicing Areas
- Military
- Environmental Remediation

General Overview

- Specifically designed for the safe recovery of jet fuel and hazardous/flammable liquids
- 55 gallon unit comes standard with lid assembly
- Air operated vacuum creates high air flow and high static lift for recovering large amounts of liquid debris quickly and safely
- Ideal for applications where electricity is not available
- Meets **General Services Administration**, Specification for Pneumatic Vacuum Cleaner, Air-Operated, for the recovery of flammable liquids. (National Stock No. 7910-00-632-9840)

Specifications	C87355-01
Wet Capacity	45 gallons (170 liters)
Dry Capacity	7.16 cu.ft. (.2 meters)
Static Lift	180+ inches (4572 mm)
Air Flow	182+ cfm (5.1 m)
Air Line Size	1/2 inch (12.7 mm)
Input Press	100 P.S.I. (7 Bar)
Input Air (CFM)	46 (1.3m/min)
Wheel Size	(4) 5 inch (12.7cm)
Weight	181 lbs. (82 kg)

Specifications subject to change without notice

Minuteman International Inc
14N845 U.S. Route 20
Pingree Grove, IL 60140
Phone: (847) 683-5210
Fax: (847) 683-5207

A Member of the Hako Group

Minuteman is a full line manufacturer of sweepers and scrubbers; as well as critical filter vacuums, industrial and commercial vacuums, floor and carpet machines, and litter vacuums for commercial and institutional facilities, whereas PowerBoss is a full line manufacturer of sweepers and scrubbers for industrial facilities.

Come Visit our Website at
www.minutemanintl.com

LEAD VACUUM

ULPA Filtered Vacuum



- **U.L.P.A filtered Vacuum** for the recovery of lead dust, paint chips and other hazardous materials. (**Ultra Low Penetration Air**) filter / 99.999% efficient @ 0.12 microns.
- **Dry Only Recovery** unit vacuums directly into a disposable Collection Bag.
- **The Lead Vacuum** has been specifically designed for safe and efficient daily use in commercial and industrial Sites.

Specifications

MODEL	C82985-06
Power	1.25 HP
Tank Size	6 gallon
Wet Capacity	N/A
Dry Capacity	4.6 cu ft
Airflow	95 CFM
Waterlift	85"
Voltage	115 v
Cord	50 ft, 16-3
Weight	17 lbs

TOOL KIT INCLUDED



P/N: 490020-1:
#20A Tool Kit. , Dry only.

- 1-1/4" x 8' Crush Proof Hose (3 cm x 2.4 m)
- 1-1/4" Telescopic wand
- 12" Crevice Tool (30 cm)
- 3" Round Dust Brush (8 cm)
- 5" Upholstery Tool (13 cm)
- Combination Floor Tool

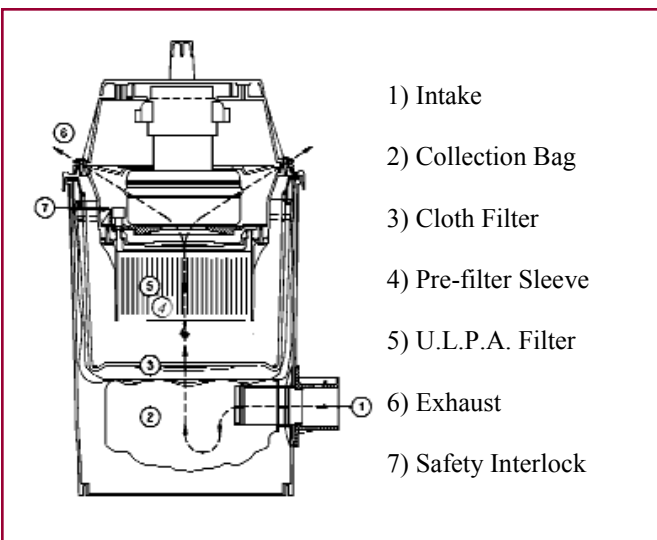

MINUTEMAN INTERNATIONAL INC.
14N845 US ROUTE 20
PINGREE GROVE, IL 60140
WEB: www.Minutemanintl.com

Phone: 800-323-9420
Fax: 800-422-6933
E-mail: customerservice@minutemanintl.com

MINUTEMAN BRAND IS A FULL LINE MANUFACTURER OF SWEEPERS AND SCRUBBERS; AS WELL AS CRITICAL FILTER VACUUMS, INDUSTRIAL AND COMMERCIAL VACUUMS, FLOOR AND CARPET MACHINES, AND LITTER VACUUMS FOR COMMERCIAL AND INSTITUTIONAL FACILITIES. POWERBOSS BRAND IS A FULL LINE MANUFACTURER OF SWEEPERS AND SCRUBBERS FOR INDUSTRIAL FACILITIES.

MRS - Mercury Recovery System

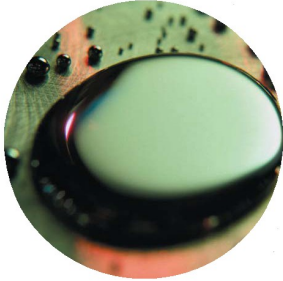

- Allows for safe, affordable clean-up of liquid mercury and mercury contaminated soil and air.
- Mercury Recovery Vacuum System can be tailored to fit almost any particular need. Designed with high-quality stainless steel.
- All units feature a 115v or 220v AC/DC air-cooled motor.
- U.L.P.A. filtration meets or exceeds the IEST-RP-CC0007 specifications

Key Features

- Extremely portable, highly maneuverable.
- U.L.P.A. filters are 99.999% effective at 0.12 microns.
- Each model contains a large capacity activated carbon filter.
- Unique modular 4-element system that allows user-tailoring to fit almost any need.
- **Tool kit**, which will handle most clean-up jobs, **is included**. P/N: 490011 Dry Only or Wet only.
P/N: 490010 Dry Only—6 Gallon.

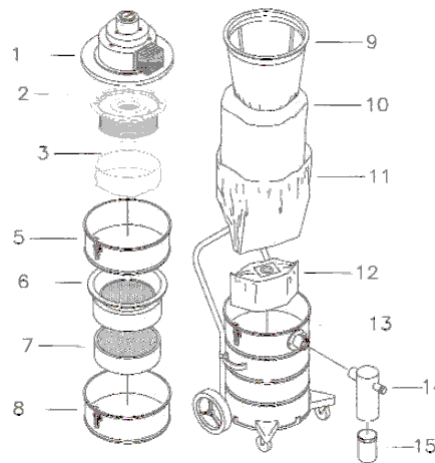

Filter System - C83015-01

1. Lid Assembly
2. U.L.P.A. Filter-110039
3. Pre Filter-110030PKG
5. Adapter
6. Filter Holder
7. Mercury Vapor Canister-761760
8. Adapter
9. Cloth Bag Assembly-805062
10. Dacron Filter-805005
11. Filter Protector-805038PKG
12. Disp. Paper Bag-760598PKG
13. Tank 15 Gallon
14. Separator
15. Separator Jar-761764



MRS2



MRS4



MRS6

Specifications

Model	C83015-01	C84015-01	C86006-11
Wet Capacity	Dry Only	15 gal. (Wet Only)	Dry Only
Dry Capacity	.82 cu. ft. (.02m3)	N/A	.62 cu ft(.02m 3/min)
Tank Size	15 gal (57 Ltr)	15 gal (57 Ltr)	6 gal (22 Ltr)
Air Flow	115CFM(3.25m 3/min)	115CFM(3.25m 3/min)	95CFM(2.7m3/min)
Waterlift	110" (2794mm)	110" (2794mm)	88" (2159mm)
Weight	78 lbs(35.5kg)	70 lbs(31.5kg)	24.5 lbs(11kg)
U.L.P.A	YES	N/A	N/A

MINUTEMAN INTERNATIONAL INC.
14N845 US ROUTE 20
PINGREE GROVE, IL 60140
WEB: www.Minutemanintl.com

Phone: 800-323-9420
Fax: 800-422-6933
E-mail: customerservice@minutemanintl.com

MINUTEMAN BRAND IS A FULL LINE MANUFACTURER OF SWEEPERS AND SCRUBBERS; AS WELL AS CRITICAL FILTER VACUUMS, INDUSTRIAL AND COMMERCIAL VACUUMS, FLOOR AND CARPET MACHINES, AND LITTER VACUUMS FOR COMMERCIAL AND INSTITUTIONAL FACILITIES. POWERBOSS BRAND IS A FULL LINE MANUFACTURER OF SWEEPERS AND SCRUBBERS FOR INDUSTRIAL FACILITIES.

MicroVac

Multi-Purpose H.E.P.A



- Dry only, three stage filtration system includes disposable collector bag, pre-filter and H.E.P.A. filter.
- H.E.P.A. filter is 99.97% efficient at 0.3 microns, tested in accordance with IEST-RP-CC007 standards.
- Quiet, powerful vacuum motor. Conveniently located on/off power switch.
- Rugged, low profile, easy to maneuver polyethylene tank design.
- Each unit includes 1 ¼" x 8' hose, telescopic operator handle, crevice, dust brush, combo floor tools and package of 10ea collector bags.
- Patented self-sealing/quick-release intake mechanism.

Specifications

MODEL	C82904-07
Power	1.25 HP
Tank Size	4 gallon
Wet Capacity	N/A
Dry Capacity	.34 cu. ft.(.01 m3/min)
Airflow	95 CFM
Waterlift	85"
Voltage	115 v
Cord	40 ft, 16-3
DbA Rating	68
Weight	16 lbs

Key Features:

1. Full bag indicator light alerts the operator that the unit is full and/or that the filters need servicing.
2. Polyethylene tank is non-corrosive and dent proof, carrying a 10 year warranty.
3. 4-stage filtration system (with optional cloth filter bag) extends life of H.E.P.A. filter.

TOOL KIT INCLUDED



P/N: 490020-1:
#20A Tool Kit. , Dry only.

- 1-1/4" x 8' Crush Proof Hose (3 cm x 2.4 m)
- 1-1/4" Telescopic wand
- 12" Crevice Tool (30 cm)
- 3" Round Dust Brush (8 cm)
- 5" Upholstery Tool (13 cm)
- Combination Floor Tool

Additional Bags And Filters:

P/N:110025 -FILTER, HEPA-MICROVAC

P/N:110027PKG -PREFILTER SLEEVE PKG OF 6

P/N:384003PKG -BAG, PAPER 380-4/6 PKG 10

MINUTEMAN INTERNATIONAL INC.
14N845 US ROUTE 20
PINGREE GROVE, IL 60140
WEB: www.Minutemanintl.com

Phone: 800-323-9420
Fax: 800-422-6933
E-mail: customerservice@minutemanintl.com

MINUTEMAN BRAND IS A FULL LINE MANUFACTURER OF SWEEPERS AND SCRUBBERS; AS WELL AS CRITICAL FILTER VACUUMS, INDUSTRIAL AND COMMERCIAL VACUUMS, FLOOR AND CARPET MACHINES, AND LITTER VACUUMS FOR COMMERCIAL AND INSTITUTIONAL FACILITIES. POWERBOSS BRAND IS A FULL LINE MANUFACTURER OF SWEEPERS AND SCRUBBERS FOR INDUSTRIAL FACILITIES.

MODEL X250 - Twin Motor Industrial Vacuum



- Twin motor industrial vacuum with HEPA filter.
- Multiple filter system helps extend the life of the H.E.P.A. filter.
- Dry pickup allows for safe recovery of most dry, hazardous dusts and non-toxic fine powders.
- Wet pickup allow for recovery of contaminated water and other liquids.
- Accepts 1 1/2", 2" or 3" hoses; top mount intake reduces clogging

Key Features

- Twin motor vacuums are equipped with powerful Ametek-Lamb motors.
- The H.E.P.A. is 99.97% efficient at 0.3 microns.
- H.E.P.A. filter meets all applicable military and ANSI specifications.
- Graduated 4-Stage filtration helps prolong the life of the H.E.P.A. filter.
- Industrial dolly, cart and dump valve make it easy to transport and empty.

Specifications

Model	C81455-05
Wet Capacity	35 Gal.
Dry Capacity	55 Gal.
Tank Size	55 gal (208 Ltr)
Decibel Rating	79 db
Water Lift	105"
FINISH	Painted
CFM	200
TOOL KIT	NOT INCLUDED

2 CORD SYSTEM- 11 AMPS EACH

AVAILABLE TOOL KITS

P/N: 490024-1

Desc: #20E Tool Kit for Wet/Dry, Commercial Grade . **Includes:-** Crush Proof Hose, 1-1/2" x 10',- Wand with Operator's Handle, 1-1/2",- Crevice Tool 12",- Round Dust Brush 3",- Upholstery Tool 5",- Slide On Bristle Brush, - Combination Floor Tool 11",- Squeegee Tool 14". **

P/N: 490025-1

Desc: #20F Tool Kit for Wet/Dry, Industrial Grade, Aluminum Tools. **Includes:** - Neoprene Hose, 1 1/2" x 10',- Wand (Operator's Handle) 1 1/2",-Crevice Tool 24",- Brush Tool 14",- Fiber Tool 14", - Squeegee Tool 14", - High Up Tool Set, - Pipe Set 4" -6", - Pipe Tool 6", - Wall Brush 10",- Swivel Hose End. **



** P/N: 800279 Adapter Sleeve Required. Not Included

MINUTEMAN INTERNATIONAL INC.
14N845 US ROUTE 20
PINGREE GROVE, IL 60140
WEB: www.Minutemanintl.com

Phone: 800-323-9420
Fax: 800-422-6933
E-mail: customerservice@minutemanintl.com

MINUTEMAN BRAND IS A FULL LINE MANUFACTURER OF SWEEPERS AND SCRUBBERS; AS WELL AS CRITICAL FILTER VACUUMS, INDUSTRIAL AND COMMERCIAL VACUUMS, FLOOR AND CARPET MACHINES, AND LITTER VACUUMS FOR COMMERCIAL AND INSTITUTIONAL FACILITIES. POWERBOSS BRAND IS A FULL LINE MANUFACTURER OF SWEEPERS AND SCRUBBERS FOR INDUSTRIAL FACILITIES.

X829 U.L.P.A. Vacuum Series



- **U.L.P.A** filtered vacuums for the safe recovery of asbestos, lead, mold, **Hexavalent** chromium and other hazardous materials.
- Available in **6 and 15 Gallon Wet /Dry** pickup applications, and a **15 Gallon dry only** version.
- **Wet/Dry recovery units** vacuum directly into a disposable 6 mil bag lined tank increasing cleaning capacity and eliminating over-handling of debris in order to help reduce decontamination time.

Key Features

- Equipped with **U.L.P.A. (Ultra Low Penetration Air)** filter / 99.999% efficient @ 0.12 microns.
- **Non-woven, embossed, polyester filter bag** provides 50% more filtration area than standard bags. **Convenient 50 foot power cord.**
- **State-of-the-art polypropylene lid assembly** is acoustically designed to minimize noise down to **72 db**. Tanks are durable, non-corrosive and dent-proof for years of reliable service.
- **Patented, self-sealing intake** ensures a positive vacuum seal while still allowing the hose to swivel for maximum cleaning convenience.
- **Patented safety interlock system** with a unique micro-switch. If the filter is not properly installed, the vacuum will not start.
- **Sure-grip quick release mechanism** makes it easy to connect and remove hoses.

Critical Filter Vacuum

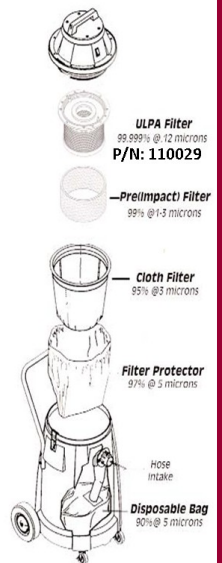

Specifications



Model	C82906-01	C82915-05	C82915-06
Wet Capacity	4.25 gal (17 Ltr)	N/A (Dry Only)	13 gal (49 Ltr)
Dry Capacity	.46 cu. ft. (.013m3)	.82 cu. Ft. (.023m3)	.82 cu. Ft. (.023m3)
Tank Size	6 gal (22 Ltr)	15 gal (57 Ltr)	15 gal (57 Ltr)
Decibel Rating	70 db	72 db	72 db
Air Flow	95 CFM (2.7m3/min)	110 CFM (3.1m3/min)	110 CFM (3.1m3/min)
Waterlift	85" (2160mm)	105" (2670mm)	105" (2670mm)
Weight	27 lbs (12 kg)	67 lbs (30 kg)	85 lbs (38 kg)
HP	1.25	2.3	2.3
Tool Kit Not Incl.	P/N: 490024-1	P/N: 490022-1	P/N: 490023-1

MINUTEMAN INTERNATIONAL INC.
14N845 US ROUTE 20
PINGREE GROVE, IL 60140
WEB: www.Minutemanintl.com

Phone: 800-323-9420
Fax: 800-422-6933
E-mail: customerservice@minutemanintl.com

MINUTEMAN BRAND IS A FULL LINE MANUFACTURER OF SWEEPERS AND SCRUBBERS; AS WELL AS CRITICAL FILTER VACUUMS, INDUSTRIAL AND COMMERCIAL VACUUMS, FLOOR AND CARPET MACHINES, AND LITTER VACUUMS FOR COMMERCIAL AND INSTITUTIONAL FACILITIES. POWERBOSS BRAND IS A FULL LINE MANUFACTURER OF SWEEPERS AND SCRUBBERS FOR INDUSTRIAL FACILITIES.

X839 H.E.P.A. Vacuum Series



The x839 HEPA Vacuum Series is ideal for the safe and economical removal of hazardous and toxic materials, nuisance dust and fine powders. The Minuteman x839 H.E.P.A. Vacuum Series is available with polyethylene, stainless steel or painted tanks to best suit your needs. This series is easy and economical to use. The Tanks: Standard as dry only units, 15, & 55 gallon vacuums have wet/dry recovery capabilities with an optional 1:1 adapter and water shut-off. The 55 gallon vacuum is equipped with a painted tank, dolly and handle for easy maneuverability.

Key Features

- Snap clamps hold lid securely to tank.
- Automatic Liquid or foam shut-off.
- Seamless molded linear polyethylene tank, noncorrosive.
- Option Wet conversion features on some models

Specifications



Model	C80106-01	C83918-00	C83905-05	C83905-16	C83905-55
Special Feature	Stainless Steel	Stainless Steel & RFI, EMI, ESD	Poly Tank	Poly Tank	Painted
Wet Capacity	N/A (Dry Only)	N/A (Dry Only)	N/A (Dry Only)	Wet/Dry	N/A (Dry Only)
Dry Capacity	.62 cu. ft.	.82 cu. Ft.	.82 cu. Ft.	2.01 cu. Ft.	7.37 cu, Ft
Tank Size	6 gal	15 gal	15 gal	15 gal	55 gal
Decibel Rating	70 db	72 db	72 db	72 db	72 db
Air Flow	95 CFM	115 CFM	115 CFM	115 CFM	115 CFM
Waterlift	85"	105"	105"	105"	105"
Filter Type— P/N:	U.L.P.A. — 110039	U.L.P.A. — 110039	H.E.P.A. — 110038	H.E.P.A. — 110038	H.E.P.A.— 110038
Tool Kit	Included	Included	Not Included	Not Included	Not Included
Tool Kit P/N:	P/N: 490012-1	RFI TOOLS	P/N: 490022-1	P/N: 490023-1	P/N: 490022-1

MINUTEMAN INTERNATIONAL INC.
14N845 US ROUTE 20
PINGREE GROVE, IL 60140
WEB: www.Minutemanintl.com

Phone: 800-323-9420
Fax: 800-422-6933
E-mail: customerservice@minutemanintl.com

MINUTEMAN BRAND IS A FULL LINE MANUFACTURER OF SWEEPERS AND SCRUBBERS; AS WELL AS CRITICAL FILTER VACUUMS, INDUSTRIAL AND COMMERCIAL VACUUMS, FLOOR AND CARPET MACHINES, AND LITTER VACUUMS FOR COMMERCIAL AND INSTITUTIONAL FACILITIES. POWERBOSS BRAND IS A FULL LINE MANUFACTURER OF SWEEPERS AND SCRUBBERS FOR INDUSTRIAL FACILITIES.